



TO LET
Minerva House
Orchard Way
Edginswell Park
Torquay TQ2 7FA



NEWLY REFURBISHED SPACE
Available as Two Suites plus Boardroom
Second Floor Office
Total NIA - 71 sq m to 362 sq m

Edginswell Park

Edginswell Park is Torquay's acknowledged prime office location, close to Riviera Way (A3022) and Hamlin Way (A380) at Kerswell Gardens and is approximately 3 miles from the city centre.

The office park has provided business space to occupiers including Kitsons Solicitors, Francis Clark and The NHS Foundation Trust and established itself as a business destination in terms of its first class location, excellent visibility and support facilities.

A new business seeking to move to Edginswell Park will be presented with an impressive top floor office suite set within a mature attractive landscaped environment.

Minerva House

This detached office building was constructed in 2010 with a modern specification and benefits from the following:

- Very Good BREEAM Environmental Assessment Award
- Fully access raised floors
- VRV ceiling mounted cooling system
- Category 5 cabling
- Excellent car parking ratio



Second Floor

Suite 1	71 sq m	764 sq ft
Suite 2	266 sq m	2,863 sq ft
Boardroom	25 sq m	270 sq ft
Total	362 sq m	3,897 sq ft

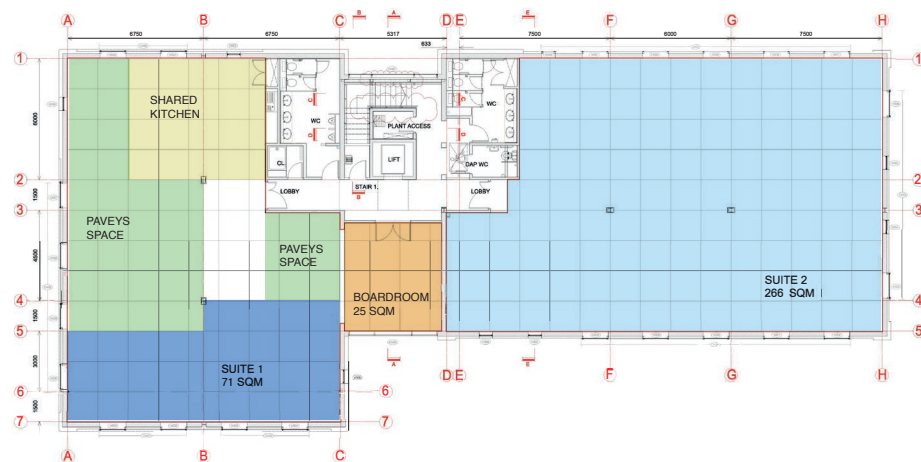

Accommodation

The building is occupied by Kitson Boyce LLP on the ground and first floors and Pavey Group Financial Services on part of the second floor.

Suite 2 contains 2 private meeting rooms and a small kitchen.

Terms

The accommodation is available on a flexible leasehold basis with incentives available.

Rent

On application to the agents.

EPC

The EPC Rating is available upon request to the agents.



Misrepresentation Act/Important Notice

The particulars contained herein are for guidance only and do not form part of a contract nor can their accuracy be guaranteed. Whilst every care is taken in the preparation of these particulars, Maze takes no responsibility for any error, mis-statement or omission in these details.

Measurements are approximate and for guidance only. All dimensions, distances, floor areas, references to condition and use and other details are given in good faith and are believed to be correct but any intending purchaser or tenant should not rely on them as statements or representations of fact but satisfy themselves by inspection or otherwise as to the correctness of each of them.

These particulars do not constitute an offer or contract and member's of the Agents' firms have no authority to make any representation or warranty in relation to the property.

Viewing

For further information or to make an appointment please contact:

Richard May

T: 01392 477 433

E: rem@maze.uk.com

M: 07790 034480

Maze 4 Barnfield Crescent,

Exeter EX1 1QT

www.maze.uk.com

